

# AGRO universal swivel adapter nickel-plated brass

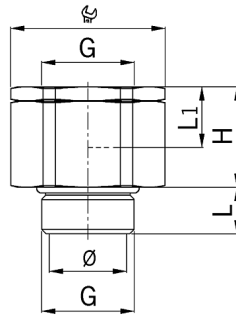

- Attention! The swivel adapter can not replace rolling- or ball bearings!
- **Material:** Nickel-plated brass
- **Sealing rings:** NBR
- **minimal operation temperature:** -40°C
- **maximum operation temperature:** +100°C
- **Protection class:** IP 68
- **Properties:** Multifunctional use in combination with cable- or conduit glands, smooth rotation due to a special bearing
- Short entry thread metric
- **Entry thread:** M25x1.5
- **Wrench size:** 36 mm
- **Dimension H:** 24 mm
- **Dimension L:** 11 mm
- **Dimension L1:** 13
- **Diameter:** 20.5 mm

## **Art. No.:** 2410.25

- **E-No.:** 126 398 600
- **Inner packaging:** ST
- **Outer packaging:** 25 ST
- **Individual net weight:** 125,040 G
- **Single volume:** 0,075 L
- **EAN:** 7611614189871
- **ETIM40:** EC001469