

# Pressure balance element with membrane increased safety Ex e II

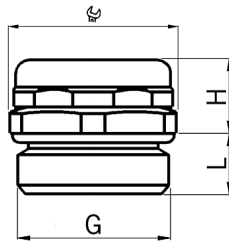

- Available on request:  
Stainless steel A2 or A4  
Entry thread Pg
- **Material:** Nickel-plated brass
- **Membrane:** PES polyethersulfone
- **O-ring:** FPM
- **minimal operation temperature:** -60°C
- **maximum operation temperature:** +100°C
- **Protection class:** IP 66 / IP 68 / IP 69
- **Test standard:** IEC EN 60079-0 / IEC EN 60079-7 / IEC EN 60079-31
- **Gas:** II 2G Ex eb IIC Gb
- **Dust:** II 2D Ex tb IIIC Db
- **Zone:** Gas 1 and 2 / dust 21 and 22
- **Certificate:** SEV 16 ATEX 0143
- **IECEX Certificate:** IECEX SEV 16.0010
  
- EX DAE
- Entry thread metric
- with membrane
- with O-ring
  
- **Entry thread:** M16x1.5
- **Wrench size:** 18 mm
- **Dimension H:** 9.5 mm
- **Dimension L:** 8 mm

## Art. No.: EX2450.17.34

- **Inner packaging:** ST
- **Outer packaging:** 20 ST
- **Individual net weight:** 20,000 G
- **Single volume:** 0,024 L
- **EAN:** 7611614297590