

EMC conduit gland for metal conduit SPR / FLEXAgraff

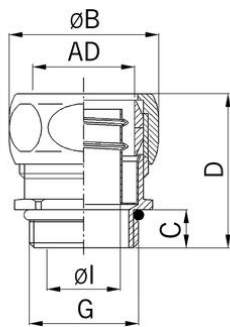

UK
CA

Complete EMC conduit connectors nickel-plated brass

- Conduit gland US-M
- for FLEXAgraff-CU-AS / SPR-EDU-AS
- with brass thrust collar

Article no:	5011.328.010
EAN:	7611614119076
Material	Nickel-plated brass
Bushing	Polished brass
Thrust collar	Polished brass
O-ring	NBR
Properties	Highly watertight and dustproof, friction locking of conduit and gland, proper earthing, covered conduit ends, resistant to stretch and vibrations
Protection class	IP 40
Operation temperature	-40°C / +250°C
Outer diameter	10 mm
Entry thread	M10x1.0
Diameter $\varnothing I$	6.0 mm
Diameter $\varnothing B$	19 mm
Dimension C	10 mm
Dimension D	31 mm
Wrench size	15/17 mm
Dispatch	50

1 = For SPR-EDU-AS

The reliability is only guaranteed with the corresponding stabilizing bush