

## Cable glands Progress® nickel-plated brass

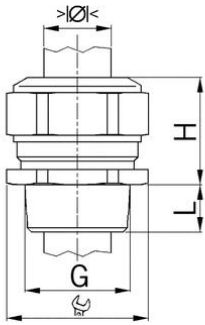

### Entry thread NPT

#### Type approval: Progress MS NPT

- One-piece sealing insert
- not overall length insulated

<b>Order number:</b>	<b>1000.1/4NPT.080</b>
EAN:	7611614116518
Material	Nickel-plated brass
Seal	TPE
Operation temperature	-40°C / +100°C
Protection class	IP 68 (up to 10 bar) / IP 69
Entry thread	NPT 1/4"
NEMA Type rating	4X
Clamping range min.	6.5 mm
Clamping range max.	8.0 mm
Wrench size	15 mm
Dimension H	17 mm
Thread length L	12 mm
UL - clamping range	7.0-8.0 mm
Dispatch	50