

## Cable glands Progress® nickel-plated brass

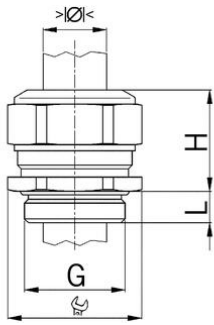

### Short entry thread metric

#### Type approval: Progress MS

- Two-piece sealing insert
- not overall length insulated

<b>Order number:</b>	<b>1000.25</b>
E-No:	121069608
EAN:	7611614104577
Material	Nickel-plated brass
Seal	TPE
O-ring	NBR
Operation temperature	-40°C / +100°C
Strain relief	Version A acc. to EN 62444
Protection class	IP 68 (up to 10 bar) / IP 69
NEMA Type rating	4X
Entry thread	M25x1.5
Clamping range with insert min.	12.5 mm
Clamping range with insert max.	16.0 mm
Clamping range without insert min.	16.0 mm
Clamping range without insert max.	20.5 mm
Wrench size	30 mm
Dimension H	28 mm
Thread length L	7 mm
UL - clamping range	14.5-16.0 mm
Dispatch	25

Available with sealing inserts conformity with EN 45545 / NFPA 130. When placing an inquiry, prefix the article number by the capital F.