

## Cable glands Progress® nickel-plated brass with trumpet and clamps

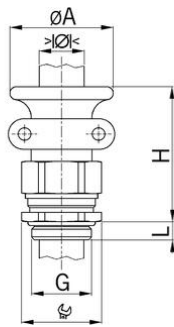

### Long entry thread Pg

- Two-piece sealing insert
- not overall length insulated

<b>Order number:</b>	<b>1801.11.16</b>
EAN:	7611614127347
Material	Nickel-plated brass
Screws	Stainless steel A2
Seal	TPE
O-ring	NBR
Operation temperature	-40°C / +100°C
Protection class	IP 68 (up to 10 bar) / IP 69
Entry thread	Pg 16
Clamping range with insert min.	8.0 mm
Clamping range with insert max.	11.0 mm
Clamping range without insert min.	11.0 mm
Clamping range without insert max.	15.0 mm
Wrench size	24 mm
Diameter A	34
Dimension H	46 mm
Thread length L	10 mm
Dispatch	50

Available with sealing inserts conformity with EN 45545 / NFPA 130. When placing an inquiry, prefix the article number by the capital F.