

Cable glands Progress® nickel-plated brass with trumpet and clamps

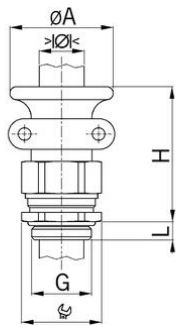

Long entry thread metric

Type approval: Progress MS T+KB

- Two-piece sealing insert
- not overall length insulated

Order number:	1801.11.40
E-No:	121431808
EAN:	7611614127460
Material	Nickel-plated brass
Screws	Stainless steel A2
Seal	TPE
O-ring	NBR
Operation temperature	-40°C / +100°C
Strain relief	Version B acc. to EN 62444
Protection class	IP 68 (up to 10 bar) / IP 69
Entry thread	M40x1.5
Clamping range with insert min.	24.0 mm
Clamping range with insert max.	28.5 mm
Clamping range without insert min.	28.5 mm
Clamping range without insert max.	33.0 mm
Wrench size	46 mm
Diameter A	57
Dimension H	59 mm
Thread length L	13 mm
Dispatch	5

Available with sealing inserts conformity with EN 45545 / NFPA 130. When placing an inquiry, prefix the article number by the capital F.