

## Clamp jaw nozzle brass

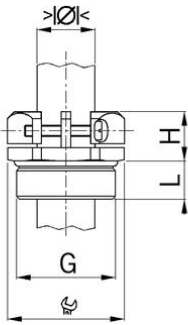

### Entry thread metric

- Mechanical strain relief B

<b>Order number:</b>	<b>1812.02</b>
E-No:	121481308
EAN:	7611614134437
Material	Nickel-plated brass
Screws	Stainless steel A2
Operation temperature	-50°C / +300°C
Strain relief	Version B acc. to EN 62444
Protection class	IP 20
Entry thread	M12x1.5
Clamping range without insert min.	5.0 mm
Clamping range without insert max.	8.0 mm
Wrench size	16 mm
Dimension H	10 mm
Thread length L	10 mm
Dispatch	50