

## Clamp jaw nozzle brass

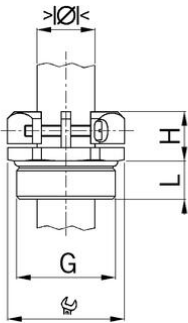

### Entry thread Pg

- Mechanical strain relief B

<b>Order number:</b>	<b>1816.02</b>
E-No:	121480408
EAN:	7611614044002
Material	Nickel-plated brass
Screws	Stainless steel A2
Operation temperature	-50°C / +300°C
Protection class	IP 20
Entry thread	Pg 16
Clamping range without insert min.	9.0 mm
Clamping range without insert max.	17.0 mm
Wrench size	27 mm
Dimension H	12 mm
Thread length L	7 mm
Dispatch	50