

Clamp jaw nozzle brass

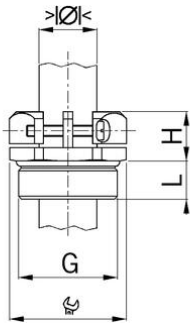

Entry thread metric

- Mechanical strain relief B

Order number:	1820.02
E-No:	121481508
EAN:	7611614134451
Material	Nickel-plated brass
Screws	Stainless steel A2
Operation temperature	-50°C / +300°C
Strain relief	Version B acc. to EN 62444
Protection class	IP 20
Entry thread	M20x1.5
Clamping range without insert min.	8.0 mm
Clamping range without insert max.	15.0 mm
Wrench size	24 mm
Dimension H	12 mm
Thread length L	10 mm
Dispatch	50