

## Clamp jaw nozzle brass

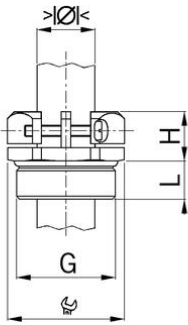

### Entry thread Pg

- Mechanical strain relief B

<b>Order number:</b>	<b>1829.02</b>
E-No:	121480608
EAN:	7611614043272
Material	Nickel-plated brass
Screws	Stainless steel A2
Operation temperature	-50°C / +300°C
Protection class	IP 20
Entry thread	Pg 29
Clamping range without insert min.	18.0 mm
Clamping range without insert max.	30.0 mm
Wrench size	42 mm
Dimension H	15 mm
Thread length L	8 mm
Dispatch	25