

Clamp jaw nozzle brass

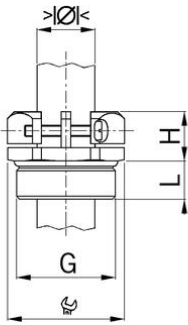

Entry thread metric

- Mechanical strain relief B

Order number:	1832.02
E-No:	121481708
EAN:	7611614134475
Material	Nickel-plated brass
Screws	Stainless steel A2
Operation temperature	-50°C / +300°C
Strain relief	Version B acc. to EN 62444
Protection class	IP 20
Entry thread	M32x1.5
Clamping range without insert min.	17.0 mm
Clamping range without insert max.	25.5 mm
Wrench size	36 mm
Dimension H	15 mm
Thread length L	13 mm
Dispatch	25