

Cable glands Progress® nickel-plated brass elbow 90°

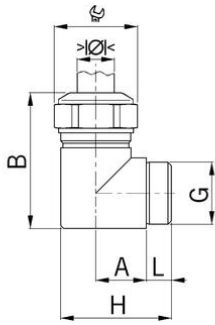

Short entry thread metric

Type approval: Progress MS W90

- Two-piece sealing insert
- not overall length insulated

Order number:	5200.25
E-No:	121501608
EAN:	7611614128658
Material	Nickel-plated brass
Seal	TPE
Operation temperature	-40°C / +100°C
Strain relief	Version A acc. to EN 62444
Protection class	IP 68
Entry thread	M25x1.5
Clamping range with insert min.	12.5 mm
Clamping range with insert max.	16.0 mm
Clamping range without insert min.	16.0 mm
Clamping range without insert max.	20.5 mm
Wrench size	30 mm
Dimension H	44 mm
Thread length L	10 mm
Dimension A	20 mm
Dimension B	52 mm
Note	-
Dispatch	25

1 = One-piece sealing insert

Available with sealing inserts conformity with EN 45545 / NFPA 130. When placing an inquiry, prefix the article number by the capital F.