

Cable glands Progress® nickel-plated brass elbow 90°

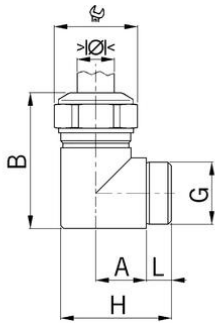

Long entry thread Pg

- Two-piece sealing insert
- not overall length insulated

Order number:	5210.07
EAN:	7611614128962
Material	Nickel-plated brass
Seal	TPE
Operation temperature	-40°C / +100°C
Protection class	IP 68
Entry thread	Pg 7
Clamping range with insert min.	- mm
Clamping range with insert max.	- mm
Clamping range without insert min.	5.0 mm
Clamping range without insert max.	6.5 mm
Wrench size	15 mm
Dimension H	30 mm
Thread length L	11 mm
Dimension A	11 mm
Dimension B	32 mm
Note	1
Dispatch	50

1 = One-piece sealing insert

Available with sealing inserts conformity with EN 45545 / NFPA 130. When placing an inquiry, prefix the article number by the capital F.