

## Cable glands Progress® nickel-plated brass elbow 90°

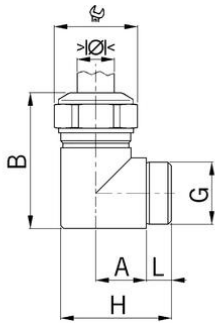

### Long entry thread metric

#### Type approval: Progress MS W90

- Two-piece sealing insert
- not overall length insulated

<b>Order number:</b>	<b>5210.12</b>
E-No:	121511308
EAN:	7611614128900
Material	Nickel-plated brass
Seal	TPE
Operation temperature	-40°C / +100°C
Strain relief	Version A acc. to EN 62444
Protection class	IP 68
Entry thread	M12x1.5
Clamping range with insert min.	- mm
Clamping range with insert max.	- mm
Clamping range without insert min.	5.0 mm
Clamping range without insert max.	6.5 mm
Wrench size	15 mm
Dimension H	30 mm
Thread length L	12 mm
Dimension A	11 mm
Dimension B	32 mm
Note	1
Dispatch	50

1 = One-piece sealing insert

Available with sealing inserts conformity with EN 45545 / NFPA 130. When placing an inquiry, prefix the article number by the capital F.