

## Cable glands Progress® nickel-plated brass elbow 90°

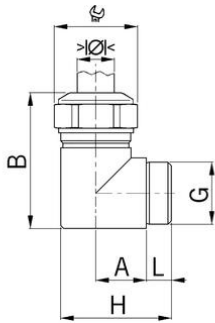

### Long entry thread metric

#### Type approval: Progress MS W90

- Two-piece sealing insert
- not overall length insulated

|                                    |                            |
|------------------------------------|----------------------------|
| <b>Order number:</b>               | <b>5210.40</b>             |
| E-No:                              | 121511808                  |
| EAN:                               | 7611614128955              |
| Material                           | Nickel-plated brass        |
| Seal                               | TPE                        |
| Operation temperature              | -40°C / +100°C             |
| Strain relief                      | Version A acc. to EN 62444 |
| Protection class                   | IP 68                      |
| Entry thread                       | M40x1.5                    |
| Clamping range with insert min.    | 24.0 mm                    |
| Clamping range with insert max.    | 28.5 mm                    |
| Clamping range without insert min. | 28.5 mm                    |
| Clamping range without insert max. | 33.0 mm                    |
| Wrench size                        | 46 mm                      |
| Dimension H                        | 66 mm                      |
| Thread length L                    | 16 mm                      |
| Dimension A                        | 28 mm                      |
| Dimension B                        | 72 mm                      |
| Note                               | -                          |
| Dispatch                           | 10                         |

1 = One-piece sealing insert

Available with sealing inserts conformity with EN 45545 / NFPA 130. When placing an inquiry, prefix the article number by the capital F.