

AGRO cable glands Progress® nickel-plated brass with trumpet and clamps in

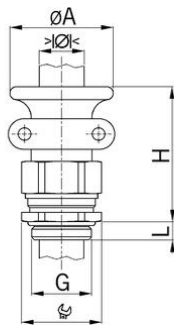

Long entry thread metric

Type approval: Progress MS T+KB EX

- Two-piece sealing insert
- not overall length insulated

Order number:	EX1811.25
E-No:	121446608
EAN:	7611614176598
Material	Nickel-plated brass
Screws	Stainless steel A2
Seal	TPE
O-ring	FPM
Operation temperature	-60°C / +100°C
Protection class	IP 66 / IP 68 (up to 10 bar)
Test standard	IEC EN 60079-0 / IEC EN 60079-7 / IEC EN 60079-31
Gas	II 2G Ex eb IIC Gb
Dust	II 2D Ex tb IIIc Db
Zone	Gas 1 and 2 / dust 21 and 22
Certificate	SEV 15 ATEX 0151
IECEx Certificate	IECEx SEV 15.0018
Entry thread	M25x1.5
Clamping range with insert min.	12.5 mm
Clamping range with insert max.	16.0 mm
Clamping range without insert min.	16.0 mm
Clamping range without insert max.	20.5 mm
Wrench size	30 mm
Diameter A	44
Dimension H	52 mm
Thread length L	11 mm
Dispatch	25