

KEL-ERM VARIO | split cable entry frames

with variable dividers, for cables with connectors / IP65 / UL Type 12/4X*

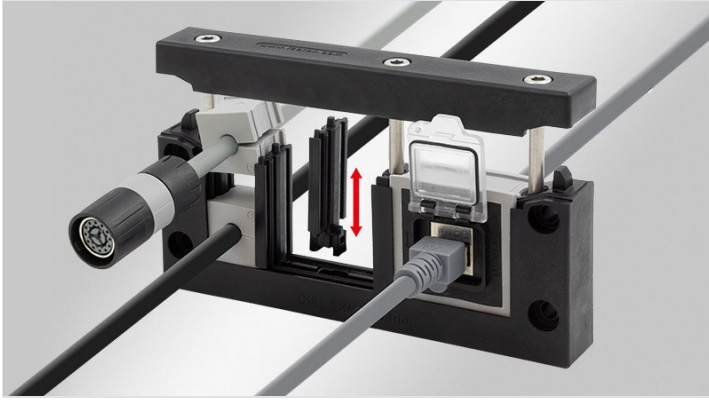

IP54



Made in Germany

IP55



IP64



IP65



UL TYPE 12



UL TYPE 4X*



The KEL-ERM VARIO is the logical further development of icotek's proven cable entry system.

It was especially designed for the routing of pre-assembled cables and offers maximum flexibility: Different configurations can be easily implemented - without having to replace the frame. A special feature are the plug-in dividers, which allow the frame to be individually adapted to the respective application. This means that the KEL-ERM VARIO can be equipped with different numbers of large or small grommets. A single base frame is sufficient for all variants of a frame size.

Note: Dividers are included in the scope of delivery.

Depending on the grommet used, cables with diameters from 1 to 16 mm (single grommets KT1 to KT15) or 16 to 35 mm (single grommets KT16 to KT34) can be securely routed, sealed with protection class IP65 / UL Type 12/4X* and strain-relieved in accordance with EN 62444.

As with the KEL-ER, the cable grommets are automatically fixed in the frame during assembly. Once fully assembled, the cover is securely screwed on.

The KEL-ERM VARIO is compatible with standard cut-outs for 10-, 16- and 24-pin heavy-duty connectors. The KEL-ERM VARIO B size is based on 46 x 46 mm cut-outs (e.g. for controllers, meters).

Thanks to the injected seal and the use of single grommets, the high IP65 protection rating is maintained even in flexible configurations.

The modular concept reduces the number of components required, saves storage space and simplifies planning, design and assembly. At the same time, it increases flexibility in enclosure construction and device integration.

This product is available in different versions: With steel screws or stainless steel screws. It is also possible to integrate threaded bushings. Please ask us about your desired variant.

The version with threaded bushings enables the cable entry frame to be screwed onto the housing from the inside out. This protects against vandalism and tampering with the housing from the outside.

*4X for indoor use only

Specifications

IP rating (EN 60529)	IP54, IP55, IP64, IP65
UL Type (UL 50E)	UL Type 12, UL Type 4X*
Material	Polyamide
Flame class	UL94-V0, self-extinguishing
Operating temperature	-40 C° to 140 C°
Properties	vibration proof, UV-resistant, silicone free, anti-corrosive (V2A versions), halogen free
Mounting options	Screw type mounting

Product types & sizes

Advantages & benefits

- Only one frame size for different variants (e.g. 24|10, 24|7, 24|4)
- Maximum flexibility thanks to plug-in dividers
- Maintain manufacturer's warranty on pre-terminated cables
- Quick retrofitting and easy servicing
- High cable density, wide variety of grommets
- Strain relief according to EN 62444
- High stability, vibration resistant
- Very easy assembly
- Can be combined with IMAS-CONNECT™ adapter grommets
- Dividers are included in the scope of delivery

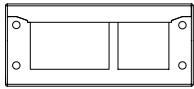
KEL-ERM VARIO 24

Part No.	68341	Height	22 mm
EAN	4251269337901	Mounting height	22 mm
Package quantity	10	Cut-out size	112 × 36 mm
For max. no. of cables	10	No. of screw holes	4
Max. cable diameter	35 mm	Diam. of screw holes	5,8 mm
Length	147 mm	Screw material	Mild steel, galvanically zinc plated
Width	65 mm		

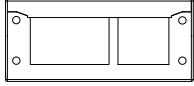
KEL-ERM VARIO 24 V2A

Part No.	68341.200	Height	22 mm
EAN	4251269337949	Mounting height	22 mm
Package quantity	10	Cut-out size	112 × 36 mm
For max. no. of cables	10	No. of screw holes	4
Max. cable diameter	35 mm	Diam. of screw holes	5,8 mm
Length	147 mm	Screw material	Stainless steel (V2A)
Width	65 mm		

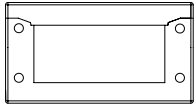
KEL-ERM VARIO 16

Part No.	68342	Height	22 mm
EAN	4251269337918	Mounting height	22 mm
Package quantity	10	Cut-out size	86 × 36 mm
For max. no. of cables	8	No. of screw holes	4
Max. cable diameter	35 mm	Diam. of screw holes	5,8 mm
Length	120 mm	Screw material	Mild steel, galvanically zinc plated
Width	65 mm		

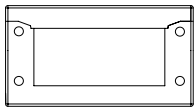
KEL-ERM VARIO 16 V2A

Part No.	68342.200	Height	22 mm
EAN	4251269337956	Mounting height	22 mm
Package quantity	10	Cut-out size	86 × 36 mm
For max. no. of cables	8	No. of screw holes	4
Max. cable diameter	35 mm	Diam. of screw holes	5,8 mm
Length	120 mm	Screw material	Stainless steel (V2A)
Width	65 mm		

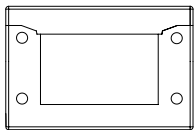
KEL-ERM VARIO 10

Part No.	68343	Height	22 mm
EAN	4251269337925	Mounting height	22 mm
Package quantity	10	Cut-out size	65 × 36 mm
For max. no. of cables	6	No. of screw holes	4
Max. cable diameter	35 mm	Diam. of screw holes	5,8 mm
Length	98 mm	Screw material	Mild steel, galvanically zinc plated
Width	65 mm		

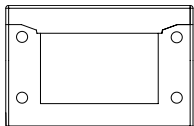
KEL-ERM VARIO 10 V2A

Part No.	68343.200	Height	22 mm
EAN	4251269337963	Mounting height	22 mm
Package quantity	10	Cut-out size	65 × 36 mm
For max. no. of cables	6	No. of screw holes	4
Max. cable diameter	35 mm	Diam. of screw holes	5,8 mm
Length	98 mm	Screw material	Stainless steel (V2A)
Width	65 mm		

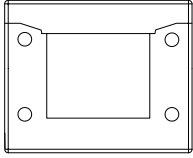
KEL-ERM VARIO B

Part No.	68344	Height	22 mm
EAN	4251269337932	Mounting height	22 mm
Package quantity	10	Cut-out size	46 × 46 mm
For max. no. of cables	4	No. of screw holes	4
Max. cable diameter	35 mm	Diam. of screw holes	5,8 mm
Length	73 mm	Screw material	Mild steel, galvanically zinc plated
Width	65 mm		

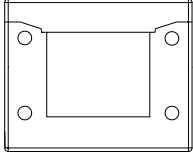
KEL-ERM VARIO B V2A

Part No.	68344.200	Height	22 mm
EAN	4251269337970	Mounting height	22 mm
Package quantity	10	Cut-out size	46 × 46 mm
For max. no. of cables	4	No. of screw holes	4
Max. cable diameter	35 mm	Diam. of screw holes	5,8 mm
Length	73 mm	Screw material	Stainless steel (V2A)
Width	65 mm		

KEL-ERM-VARIO divider

Part No.	68345
EAN	4251269338069
Package quantity	10

icotek[®]
smart cable management