

Part number

# CDSM 42



Male insert, CDS series, spring terminal connection, 42 poles + PE, 10 A 400 V 6 kV 3, size "104.27"

## Product description

|                        |  |
|------------------------|--|
| <b>Product type</b>    | Insert   |
| <b>Series</b>          | CDS  |
| <b>Connection type</b> | Spring terminal connection   |
| <b>Gender</b>          | Male   |
| <b>N. of poles</b>     | 42 poles +  |
| <b>Size</b>            | Size 104.27  |

## Technical data

|  |  |
|--|--|
| <b>Current</b>                           | 10 A   |
| <b>Voltage</b>                           | 400 V  |
| <b>Rated impulse withstand voltage</b>   | 6 kV   |
| <b>Pollution degree</b>                  | 3  |
| <b>Rated voltage according to UL/CSA</b> | 600 V  |
| <b>Wire cross-section</b>                | 0,14 mm <sup>2</sup> - 2,50 mm <sup>2</sup>                |
| <b>AWG size</b>                          | 26 - 14  |
| <b>Contact type</b>                      | Turned silver plated                                       |
| <b>IP degree of protection</b>           | IP20 without enclosure, IP65/IP66/IP68/IP69 with enclosure |

## Further technical details

|   |                                    |
|---|------------------------------------|
| <b>Characteristics according to EN 61984</b>  | 10A 400V 6kV 3; 10A 400/690V 6kV 2 |
| <b>Mating cycles</b>                          | ≥ 500                              |
| <b>Insulation resistance</b>                  | ≥ 10 GΩ                            |
| <b>Contact resistance</b>                     | ≤ 3 mΩ                             |
| <b>Weight</b>                                 | 115,00 g                           |
| <b>Operating temperature range (min, max)</b> | -40 °C ... +125 °C                 |
| <b>Conductors stripping length</b>            | 9...11 mm                          |
| <b>UL 94 flammability rating</b>              | V-0                                |

## Material properties

|                              |  |
|------------------------------|--|
| <b>Main material</b>         | Polycarbonate (PC)   |
| <b>Colour</b>                | RAL 7032 grey  |
| <b>RoHs conformity</b>       | Compliant with exemption 6(c): copper alloy containing up to 4% lead by weight |
| <b>China RoHs - EFUP</b>     | 50   |
| <b>REACH SVHC substances</b> | Yes<br>Lead  |
| <b>SCIP number</b>           | 1a9c93ff-0445-4a16-81e3-1609ac5274d6   |

## Approvals / Standards

|                           |                        |
|---------------------------|------------------------|
| <b>Reference standard</b> | EN 61984:2009-06       |
| <b>Certifications</b>     | CSA, CQC, DNV, BV, EAC |
| <b>UL</b>                 | ECBT2                  |
| <b>cUL</b>                | ECBT8                  |

## General ordering information

|                   |               |
|-------------------|---------------|
| <b>EAN13 code</b> | 8015747148528 |
| <b>ETIM 7.0</b>   | EC000438      |

## Packaging Information

|                                  |                      |
|----------------------------------|----------------------|
| <b>Packaging length</b>          | 270,00 mm            |
| <b>Packaging height</b>          | 75,00 mm             |
| <b>Packaging width</b>           | 180,00 mm            |
| <b>Packaging weight</b>          | 3,84 kg              |
| <b>Packaging volume</b>          | 3,65 dm <sup>3</sup> |
| <b>Packaging description</b>     | Carton box           |
| <b>Packaging quantity</b>        | 30 Pcs               |
| <b>Packaging EAN code</b>        | 8015747152433        |
| <b>Sub-packaging length</b>      | 113,00 mm            |
| <b>Sub-packaging height</b>      | 36,00 mm             |
| <b>Sub-packaging width</b>       | 180,00 mm            |
| <b>Sub-packaging weight</b>      | 0,64 kg              |
| <b>Sub-packaging volume</b>      | 0,73 dm <sup>3</sup> |
| <b>Sub-packaging description</b> | Carton tray          |
| <b>Sub-packaging quantity</b>    | 5 Pcs                |
| <b>Sub-packaging EAN barcode</b> | 8015747152440        |

Part number

# CDSM 42



## Catalogue drawings

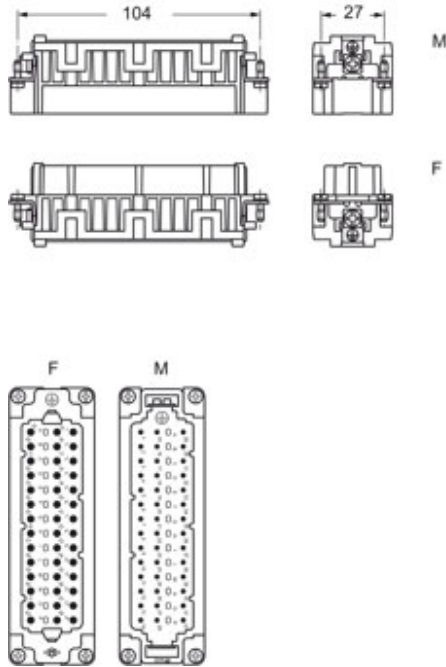

## Notes

### CDSF/M 42 inserts

- characteristics according to EN 61984:  
10A 400V 6kV 3
  - insulation resistance: > 10 GOhm
  - ambient temperature limit: -40 °C ... +125 °C
  - made of self-extinguishing thermoplastic resin UL 94 V0
  - mechanical life: > 500 cycles
  - contact resistance: < 1 mOhm
  - inserts for conductors section:  
0.14 - 2.5 mm<sup>2</sup> - AWG 26 - 14
  - for wires with crimped ferrule, usable section:  
up to 1.5 mm<sup>2</sup> (AWG 16)
  - conductors stripping length: 9...11 mm
  - enclosures: size 104.27:
- C-TYPE IP65/IP66  
C7 IP67 stainless steel lever  
V-TYPE IP65/IP66 stainless steel lever  
T-TYPE IP65 insulating  
JEI zinc-plated steel lever  
BIG hoods  
W-TYPE for aggressive environment  
EMC  
central lever  
IP68  
LS-TYPE  
- panel supports: COB

Dimensions shown in mm are not binding and may be changed without notice.

Connection with spring terminal

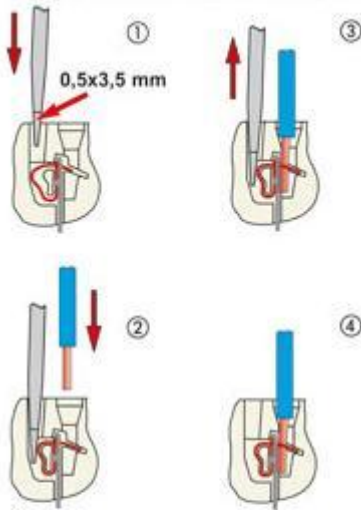

CR CDS coding pin

### California Proposition 65 Information



### WARNING

This product can expose you to lead and its compounds, known to the State of California to cause cancer and/or reproductive toxicity. For more information go to [www.P65Warnings.ca.gov](http://www.P65Warnings.ca.gov).

### California Proposition 65 Information



### WARNING

This product can expose you to lead and its compounds, known to the State of California to cause cancer and/or reproductive toxicity. For more information go to [www.P65Warnings.ca.gov](http://www.P65Warnings.ca.gov).