

Part number

CSAHF 10



Female insert, CSAH series, SQUICH® spring terminal connection without tools, 10 poles + PE, 16 A 250 V 4 kV 3, size "49.16"

Product description		Material properties	
Product type	Insert	Main material	Polycarbonate (PC)
Series	CSAH	Other materials	Contacts: copper alloy
Connection type	SQUICH® spring terminal connection without tools	Colour	RAL 7032 grey
Gender	Female	RoHs conformity	Compliant with exemption 6(c): copper alloy containing up to 4% lead by weight
N. of poles	10 poles + 	China RoHs - EFUP	50
Size	Size 49.16	REACH SVHC substances	Yes Lead
Technical data		SCIP number	1a9c93ff-0445-4a16-81e3-1609ac5274d6
Current	16 A	Approvals / Standards	
Voltage	250 V	Reference standard	EN 61984:2009-06
Rated impulse withstand voltage	4 kV	Certifications	DNV, BV, EAC, CQC
Pollution degree	3	UL	ECBT2
Rated voltage according to UL/CSA	600 V	cUL	ECBT8
Wire cross-section	0,14 mm ² - 2,50 mm ²	General ordering information	
AWG size	26 - 14	EAN13 code	8015747214575
Contact type	Turned silver plated	eCl@ss 8.1	27440205
IP degree of protection	IP20 without enclosure, IP65/IP66 with enclosure	ETIM 7.0	EC000438
Further technical details		Packaging Information	
Characteristics according to EN 61984	16A 250V 4kV 3; 16A 230/400V 4kV 2	Packaging weight	1,62 kg
Mating cycles	≥ 500	Packaging volume	3,29 dm ³
Insulation resistance	≥ 10 GΩ	Packaging description	Carton box
Contact resistance	≤ 3 mΩ	Packaging quantity	30 Pcs
Weight	47,00 g	Packaging EAN code	8015747214612
Operating temperature range (min, max)	-40 °C ... +125 °C	Sub-packaging length	127,00 mm
Conductors stripping length	9...11 mm	Sub-packaging height	45,00 mm
UL 94 flammability rating	V-0	Sub-packaging width	63,00 mm
Tightening torque for PE connection	M3,5: 0,8 Nm; 7,1 lb.in (Ph1 or 0,8 x 5,5 mm)	Sub-packaging weight	0,27 kg
		Sub-packaging volume	0,36 dm ³
		Sub-packaging description	Carton tray
		Sub-packaging quantity	5 Pcs
		Sub-packaging EAN barcode	8015747214629

Part number
CSAHF 10



Notes

Dimensions shown in mm are not binding and may be changed without notice.

California Proposition 65 Information



WARNING

This product can expose you to lead and its compounds, known to the State of California to cause cancer and/or reproductive toxicity. For more information go to www.P65Warnings.ca.gov.

California Proposition 65 Information



WARNING

This product can expose you to lead and its compounds, known to the State of California to cause cancer and/or reproductive toxicity. For more information go to www.P65Warnings.ca.gov.

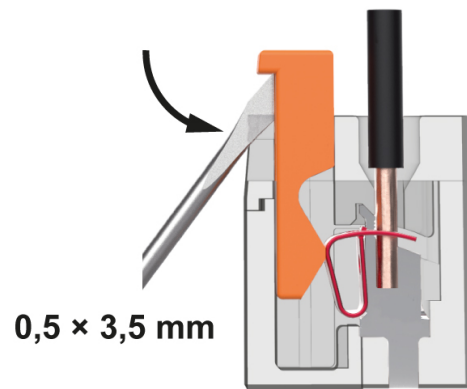
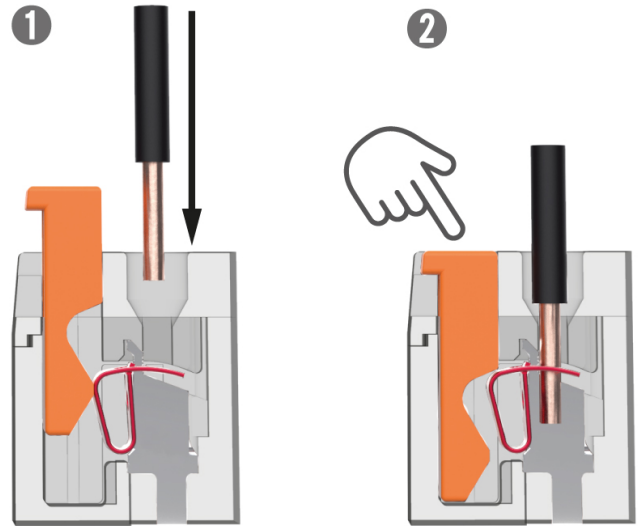

Reopening

SQUICH® connection with actuator button