

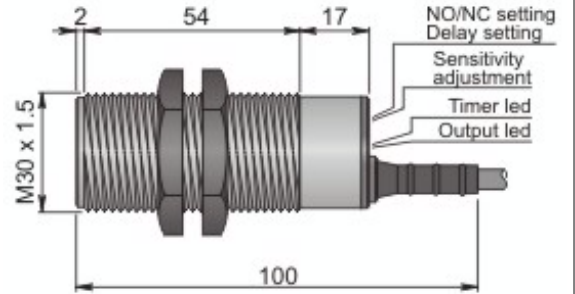

**Part number: C30000149 - Model: SC30SP-A20 TE1 NO/NC**



Dimension in mm

### TECHNICAL CHARACTERISTICS

|                              |  |
|------------------------------|--|
| Working voltage:             | 20 ÷ 250 Vac                             |
| Output type:                 | AC                                       |
| Function:                    | NO/NC programmable                       |
| Actuation type:              | Delayed                                  |
| Delay range (min):           | 0 ÷ 1                                    |
| Sensing distance (mm):       | 0 ÷ 20 (adjustable)                      |
| Hysteresis (%Sn):            | < = 20                                   |
| Max. switching frequency:    | Max = 10 Hz / min = In relation to delay |
| Repeatability (%Sn):         | < 10                                     |
| Max. output current:         | 500 mA                                   |
| Min. output current:         | 10 mA (minimum current for relèase)      |
| Max peak current for 20msec: | 1.5 A                                    |
| Residual current:            | < = 2 mA                                 |
| Voltage drop:                | < 6 V                                    |
| Led indicator:               | Yellow = output / Blinking blue = timer  |
| Shielding:                   | Embeddable                               |
| Mechanical characteristics:  | M30x1.5                                  |
| Housing material:            | Plastic                                  |
| Connection type:             | Cable 3 m                                |
| Cable type:                  | 3x0.35 PVC                               |
| Temperature limits:          | -20 ÷ +70 °C                             |
| IP rating:                   | IP 67                                    |
| Weight:                      | 300 g                                    |



Part number: C30000149 - Model: SC30SP-A20 TE1 NO/NC

## WIRING DIAGRAM

### 2 WIRES + GROUND CABLE (NO/NC Programmable)



## INSTRUCTIONS FOR CORRECT INSTALLATION

### INSTRUCTIONS FOR CORRECT INSTALLATION

#### EMBEDDABLE

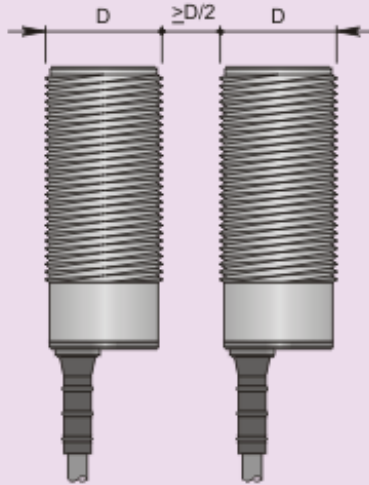

Side by side mounting

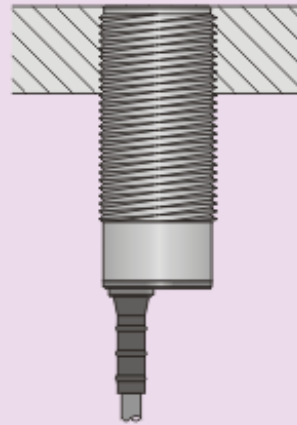

Flush mounting

## REAR VIEW

