

Optisch-akustische Signalgeber Sounder-Beacon Units

FLASHNI

- | Hoher Schallpegel
- | Mit Switch Board zur Tonauswahl erhältlich
- | Automatische Synchronisation
- | Lautstärkeregelung
- | Kombination verschiedener Farben
- | Xenon-Blitz
- | Separat ansteuerbar



FLASHNI

- | High sound output
- | Switch board version available
- | Automatic synchronisation
- | Volume control
- | Combination of different colours
- | Xenon flash
- | Controlled separately

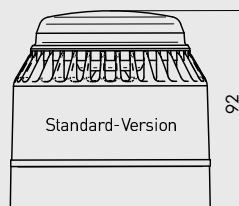

Shallow Base (IP54)
Standard-Unterteil

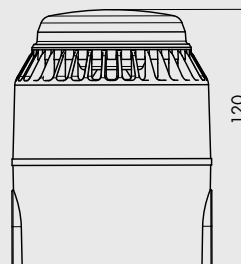

Deep Base (IP65)
IP65-Unterteil

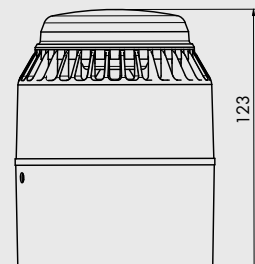

U-Base (IP65)
IP65-Unterteil +2

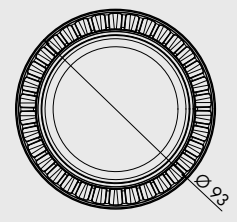
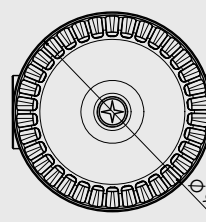
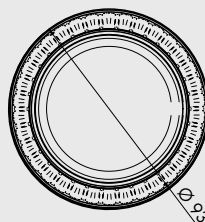

SPEZIFIKATIONEN | SPECIFICATIONS

Model	FLASHNI 12 V DC	FLASHNI 24 V DC
Spannungsbereich Operating voltage	9 – 15 V DC	18 – 28 V DC
Stromaufnahme Current consumption	83 – 111 mA/87 mA bei DIN-Ton 83 – 111 mA/87 mA @ DIN-Tone	59 – 85 mA/66 mA bei DIN-Ton 59 – 85 mA/66 mA @ DIN-Tone
Lautstärke Sound output	75 – 104 dB(A)/94 dB(A) bei DIN-Ton 75 – 104 dB(A)/94 dB(A) @ DIN-Tone	83 – 110 dB(A)/98 dB(A) bei DIN-Ton 83 – 110 dB(A)/98 dB(A) @ DIN-Tone
Signaltöne Alarm tones	32	32
Schutzklasse IP rating	IP54 (Shallow Base)/IP65 (Deep Base, U-Base)	IP54 (Shallow Base)/IP65 (Deep Base, U-Base)
Temperaturbereich Operating temperature	-10 °C bis +55 °C -10 °C to +55 °C	-10 °C bis +55 °C -10 °C to +55 °C
Gehäusefarbe Body colour	rot oder weiß red or white	rot oder weiß red or white
Linsefarbe Lens colour	rot, gelb oder klar red, amber, clear	rot, gelb, oder klar red, amber, clear
Material Construction	ABS FR	ABS FR
Material Sockel Construction base	PC	PC
Zulassungen Approvals	VdS (G206021), CPD	VdS (G206021), CPD