

Hour meters / timers, electromechanical

Standard timers	9999.99 h / 99999.9 h with reset (AC+DC)	HB 26
------------------------	---	--------------



The timer HB 26 with reset measure time ranges up to max. 99999.9 h or 9999.99 h.

These panel-mount counters can be used in many different fields of application.

Characteristics

- 6-digit hour meter without reset.
- High shock and impact resistance.
- Magnified large figures; height 4.5 mm.
- Data retention in case of power failure.
- Long service life.
- Plug-in versions.
- Counter without front bezel for mounting in front bezel F1B and F2B and for combination in 50 x 25 mm size with socket box 945.2.

Benefits

- Can be combined with preset counters BVa and HVa, and with pulse counter B.
- Can be equipped with various sealing covers to protect the counter against dust, dirt and moisture.
- Key-locking 0-reset.

Applications

General time measurement, maintenance intervals for measuring instruments (respiration units, oxygen, dialysis), small appliances, UV lamps, display panels in vehicles.

Type series

Description

Screw mounting, 56 x 40 mm [2.20 x 1.57"]

Clip mounting, 53 x 28 mm [2.09 x 1.10"]

Plug-in for socket box 945.2 and front bezel F1B

Type

HB 26.11

HB 26.21

HB 26.01.3

Options

- Different voltages
- Extended temperature range on request
- Flat pin 0.8 x 6.3 mm [0.031 x 0.25"] without flat push on connectors: Art.-Nr. 3.168.X11.XXX
- Flat pin 0.8 x 2.8 mm [0.031 x 0.11"] with flat push on connectors: Art.-Nr. 3.167.X11.XXX
- Lockable 0-reset: Art.-Nr. 3.160.XX7.XXX
The button can be unlocked by means of the key



Hour meters / timers, electromechanical

Standard timers	9999.99 h / 99999.9 h with reset (AC+DC)	HB 26
------------------------	---	--------------

Accessories / Mounting examples

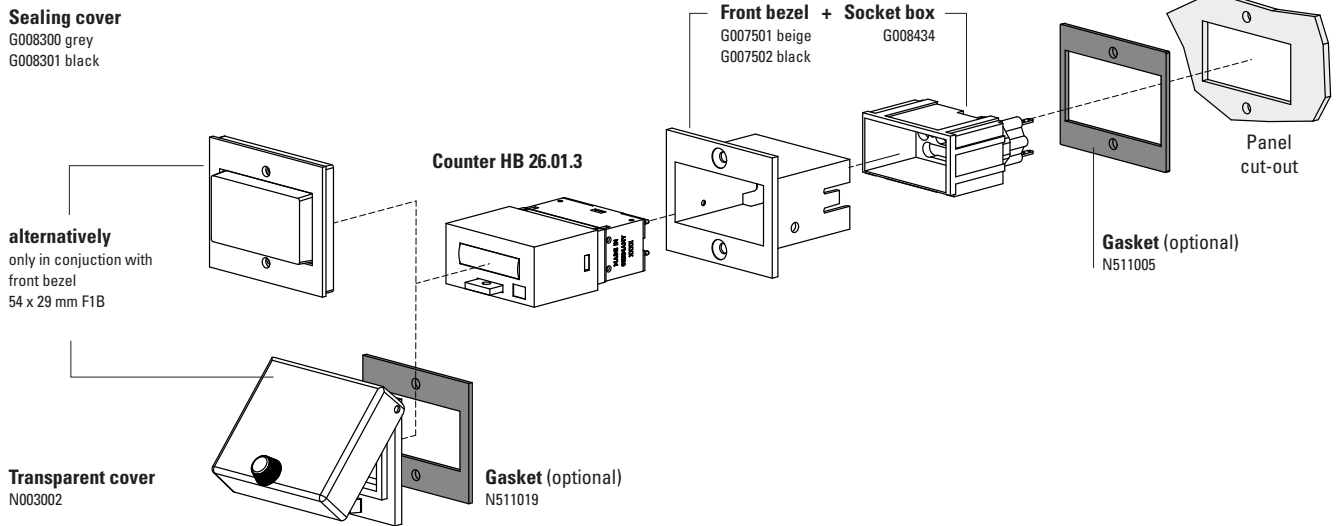

		Type / size	Description		Order no.	suitable gasket
Front bezel		F1B	for 1x counter HB 26.01.3 for cut-out 54 x 29 mm [2.13 x 1.14"] (only in conjunction with socket box G008434)	beige black	G007501 G007502	N511005
		F2B	for 2x counter HB 26.01.3 for cut-out 54 x 54 mm [2.13 x 2.13"] (only in conjunction with 2 x socket box G008434)	beige black	G007503 G007504	N511003
Socket box		945.2	for plug-in connection in front bezel F1B	black	G008434	–
Sealing cover IP65		K1	for counter HB 26.01.3 in conjunction with front bezel F1B	transp. /grey transp. /black	G008300 G008301	–
		K2	only in conjunction with front bezel F2B (for 2x counter HB 26.01.3)	transp. /grey transp. /black	G008302 G008303	
Transparent cover IP65		1 Dv	cover lockable for counter HB 26.01.3 in conjunction with front bezel F1B	transp. /black	N003002	N511019
		2 Dv	cover lockable only in conjunction with front bezel F2B	transp. /black	G008143	
		2 Dvs	cover key lockable only in conjunction with front bezel F2B	transp. /black	G008153	
Gasket counter			56 x 40 mm [2.20 x 1.57"] 53 x 28 mm [2.09 x 1.10"]	HB 26.11 HB 26.21	N511045 N511015	
Mounting frame		cut-out 50 x 25 mm [1.97 x 0.98"]	via adapter T008180 for snap-on mounting on 35 mm [1.38"] top-hat DIN rail	chromated	G300004	–
Enclosure blind		48 x 24 mm [1.89 x 0.94"]	for cut-out 50 x 25 mm [1.97 x 0.98"], for counter 53 x 28 mm [2.09 x 1.10"]	black	T005753	–
DIN rail mount		SR 1	for snap-on mounting on 35 mm [1.38"] top-hat DIN rail		G300000	
		SR 2	for 2x HB 26		G300001	

Hour meters / timers, electromechanical

Standard timers	9999.99 h / 99999.9 h with reset (AC+DC)	HB 26
------------------------	---	--------------

Technical data

Electrical characteristics			General technical data		
Electrical connection	cable	2 x 0.5 mm ² [AWG20], NYFAZ, 0.5 m [1.64'] long AC: grey/grey, DC: red +, black – type HB 26.01.3 round pins ø 1.6 mm [0.063"] (plugs into socket box type 945.2)	Display	number of digits	6, AC: 9999.99 h, DC: 99999.9 h
Power consumption	10 ... 30 V DC	approx. 500 mW	height of figures	4.5 mm [0.17"]	
	36 ... 80 V DC	approx. 900 mW	color of figures	white and red on black	
	100 ... 130 V DC	approx. 750 mW	Operating temperature	-15 °C ... +50 °C [+5 °F ... +122 °F]	(non-condensing)
	20 ... 30 V AC	approx. 0.3 VA	Relative humidity	≤ 80 % (non-condensing)	
	42 ... 48 V AC	approx. 0.25 VA	Altitude	up to 2000 m [6562']	
	100 ... 130 V AC	approx. 0.6 VA	Mounting position	any	
	187 ... 264 V AC	approx. 1.2 VA			
	360 ... 440 V AC	approx. 1.65 VA			
Rated voltages	AC (50 or 60 Hz)	20 ... 30 / 42 ... 48 / 100 ... 130 / 187 ... 264 / 360 ... 440 V AC	Mechanical characteristics		
	DC	10 ... 30 / 36 ... 80 / 100 ... 130 V DC	Housing	plastic PC (Polycarbonate)	
Accuracy	AC	supply frequency + 30 ms	Protection	IP41 (front side)	
	DC	< 0.003 % (at 24 h)	with flexible sealing cover K1	IP54 (front side)	
EMC standards		EN 55011 class B EN 61000-6-2, EN 61000-6-3	with transparent cover Dv, Dvs	IP55 (front side)	
Device safety	designed to protection class application area	EN 61010 part 1 2 pollution level 2	Weight	approx. 45 g [1.59 oz]	
			Options		
			Different voltages and extended temperature range on request		
			Flat pin 0.8 x 6.3 mm [0.031 x 0.25"] without flat push on connectors		Art. no. 3.168.X11.XXX
			Flat pin 0.8 x 2.8 mm [0.031 x 0.11"] with flat push on connectors		Art. no. 3.167.X11.XXX
			Key-locking 0-reset		Art. no. 3.160.XX7.XXX

Hour meters / timers, electromechanical

Standard timers **9999.99 h / 99999.9 h with reset (AC+DC)** **HB 26**

Screw mounting, 56 x 40 [2.20 x 1.57]
Type HB 26.11

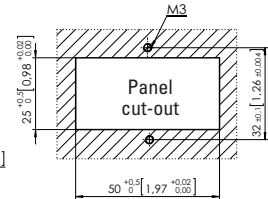
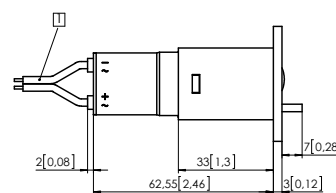
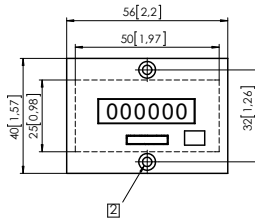

1) Connection cable, 2 x 0.5 mm² [AWG20], NYFAZ, 0.5 m [1.64'] long 2) Countersinking Af3, DIN 74

Type	Display	Voltage	Art. no.						
			10 ... 30 V	20 ... 30 V	36 ... 80 V	42 ... 48 V	100 ... 130 V	187 ... 264 V	360 ... 440 V
HB 26.11	6 digits	AC (50 Hz)		3.160.111.071		3.160.111.072	3.160.111.074	3.160.111.075 ¹⁾	3.160.111.079
	6 digits	AC (60 Hz)		3.160.111.081		3.160.111.082	3.160.111.084	3.160.111.085	3.160.111.089
	6 digits	DC	3.160.111.351 ¹⁾		3.160.111.353		3.160.111.381		

Clip mounting, 53 x 28 [2.09 x 1.10]
Type HB 26.21

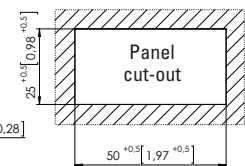
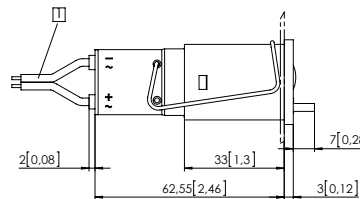
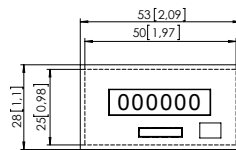

1) Connection cable, 2 x 0.5 mm² [AWG20], NYFAZ, 0.5 m [1.64'] long

Type	Display	Voltage	Art. no.						
			10 ... 30 V	20 ... 30 V	36 ... 80 V	42 ... 48 V	100 ... 130 V	187 ... 264 V	360 ... 440 V
HB 26.21	6 digits	AC (50 Hz)		3.160.211.071		3.160.211.072	3.160.211.074	3.160.211.075 ¹⁾	3.160.211.079
	6 digits	AC (60 Hz)		3.160.211.081		3.160.211.082	3.160.211.084	3.160.211.085	3.160.211.089
	6 digits	DC	3.160.211.351 ¹⁾		3.160.211.353		3.160.211.381		
Further stock types:			187... 264 V AC, key lockable reset				3.160.217.075		
			187... 264 V AC, flat pin 0.8 x 2.8 mm [0.031 x 0.11"]				3.167.211.075		
			10 ... 30 V DC, flat pin 0.8 x 2.8 mm [0.031 x 0.11"]				3.167.211.351		

Hour meters / timers, electromechanical

Standard timers **9999.99 h / 99999.9 h with reset (AC+DC)** **HB 26**

Plug-in for socket box 945.2 and front bezel F1B

Type HB 26.01.3

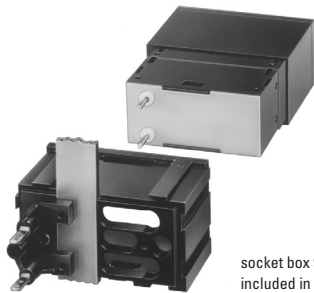

socket box 945.2 not included in delivery

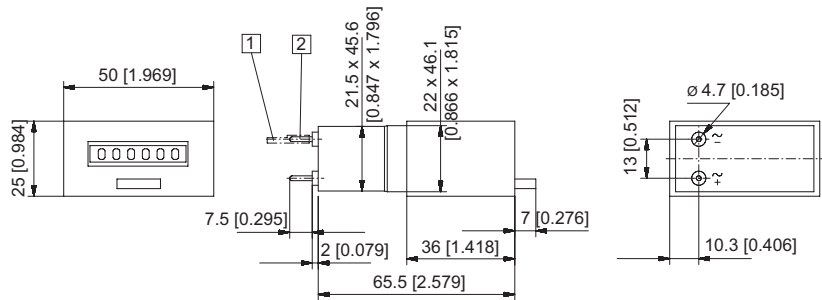

1 Push on connector \varnothing 1.5 [0.059] tinned 2 Round pin \varnothing 1.6 [0.063] tinned

Type	Display	Voltage	Art. no.						
			10 ... 30 V	20 ... 30 V	36 ... 80 V	42 ... 48 V	100 ... 130 V	187 ... 264 V	360 ... 440 V
HB 26.01.3	6 digits	AC (50 Hz)		3.165.011.071		3.165.011.072	3.165.011.074	3.165.011.075	3.165.011.079
	6 digits	AC (60 Hz)		3.165.011.081		3.165.011.082	3.165.011.084	3.165.011.085	3.165.011.089
	6 digits	DC	3.165.011.351		3.165.011.353		3.165.011.381		